

ST-265 Swiss type automatic lathe

—Sliding Headstock Type

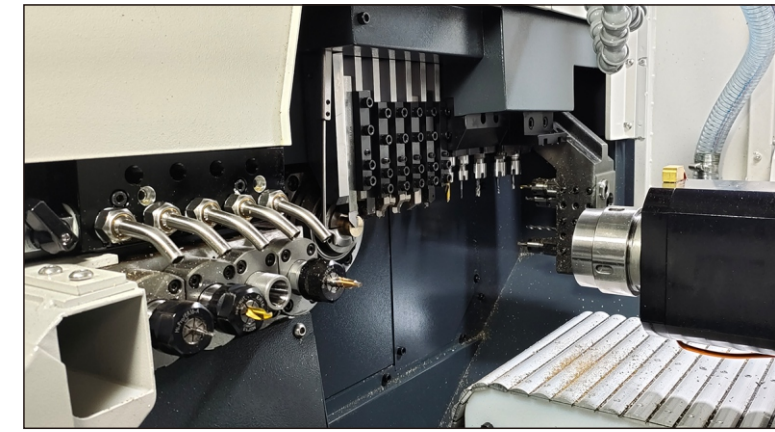

- ▶ Machining Max. dia.26mm,length 240mm workpiece.
- ▶ Main and back spindle with two-channel control.
- ▶ Temperature compensation program improve workpiece precision when cold start.
- ▶ Chip breaking function by low frequency vibration technology.(optional)
- ▶ Cut-off tool breakage detector.

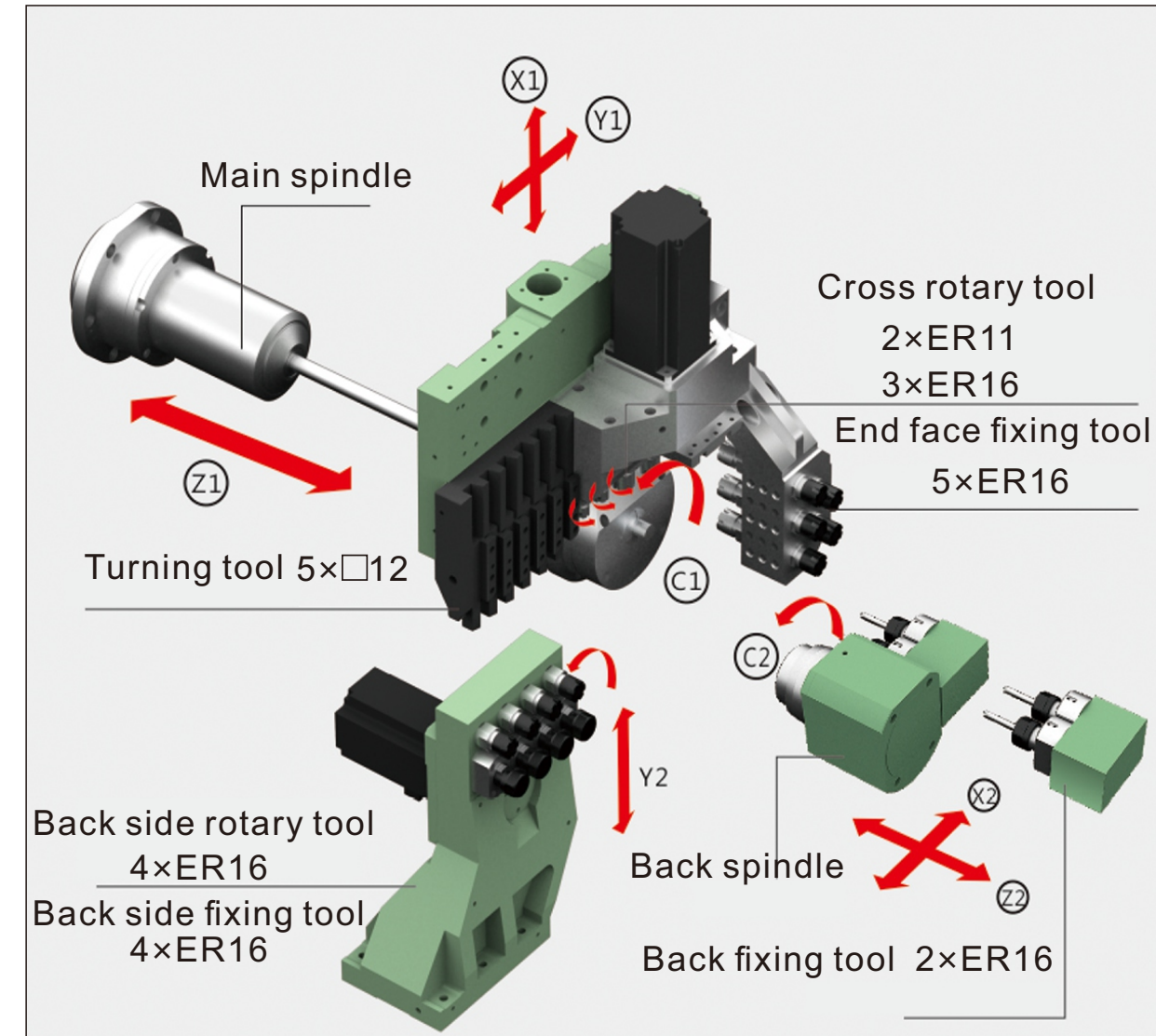

ST-265 Standard tool holder with 20 pcs
Main and back spindle with two-channel control.

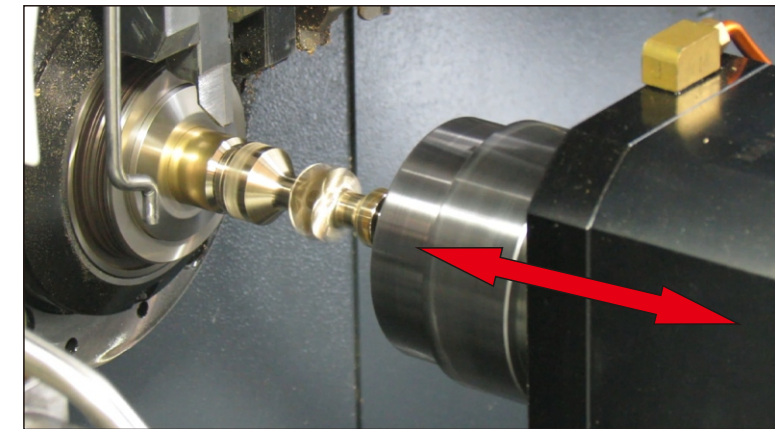

Back spindle butt joint workpiece with main spindle.

Model different tool post	I	II	ST-266
Back side fixing tool	4	/	4(Y2)
Back side rotary tool	/	4	4(Y2)
Back spindle fixing tool	2	2	2

Representation of the cutting



Comparison of chips

Material SUS304 Weight: 14.3 g (same scale)



Chips generated by customary cutting

Chips generated with LFV cutting



Position adjustable operation panel

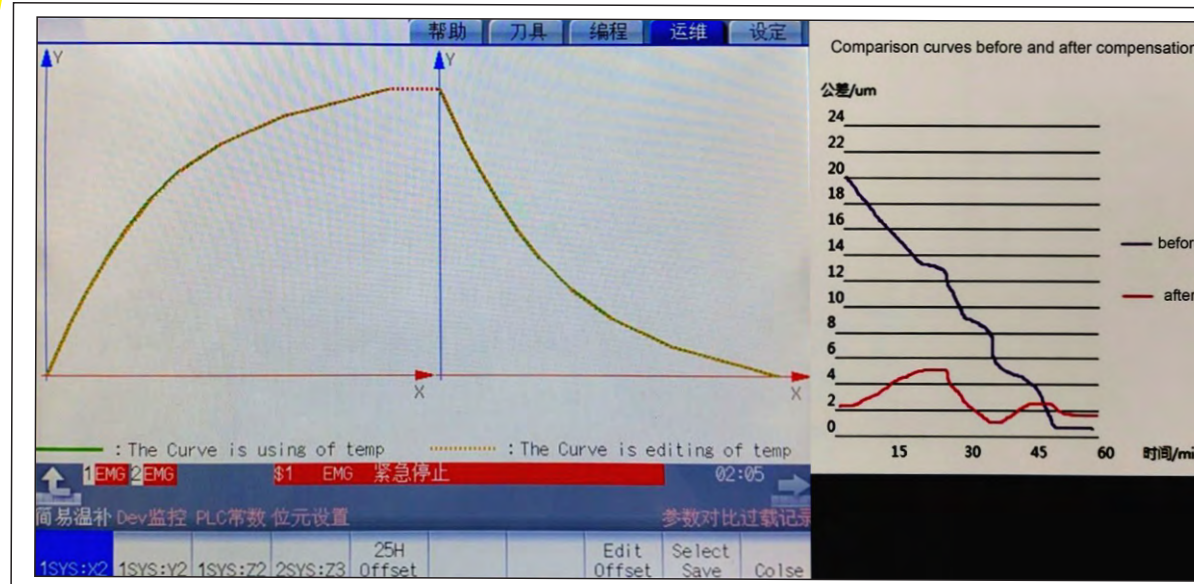

Mitsubishi M80 control system with 2nd development interface, temperature compensation program let workpiece stable continuous machining, improve precision and quality rate.

Air pressure detector



Main spindle is 8000rpm motor spindle

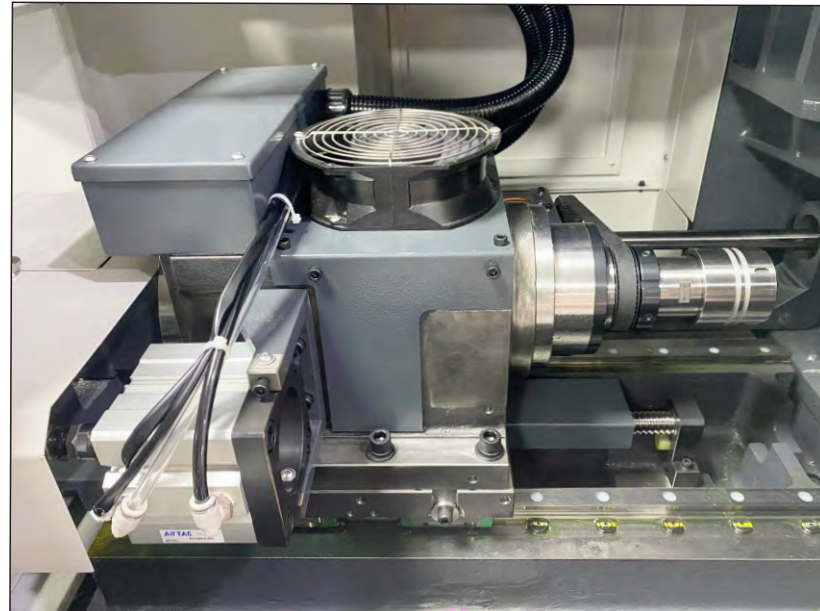

Back axis tool expansion

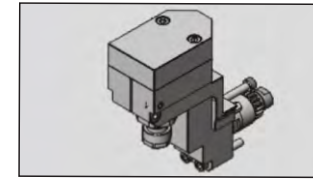

Radial drilling and milling tool holder

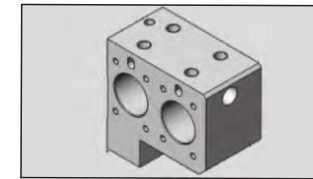

Expansion tool holder

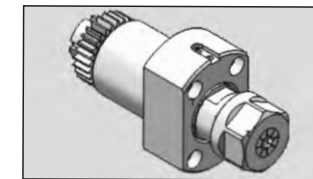

Axial drilling and milling tool holder

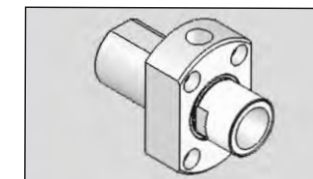

Axial drilling tool holder

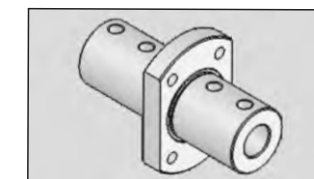

Boring tool holder

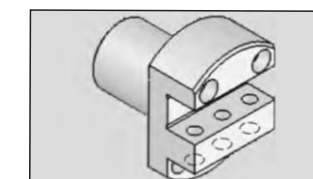

Turning tool holder

Extended tool holder with power head

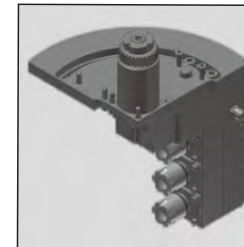

Angle adjustment front eccentric holder
 Maximum speed: 6000RPM
 Working angle: 0~90°
 Main spindle: ER16
 Back spindle: ER11

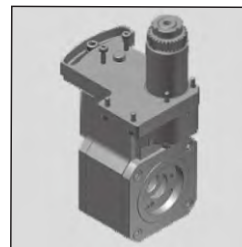

Whirling milling holder
 Maximum speed: 6000RPM
 Max size of milling tooth: M10
 Angle adjustment range: ±15°

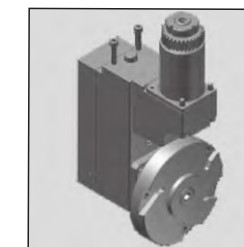

Multi-milling holder
 Maximum speed: 3000RPM
 Maximum outer diameter of blade: ø95

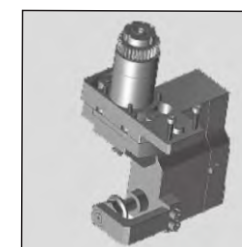

Gear hobbing holder
 Maximum speed: 6000RPM
 Angle adjustment range: ±15°

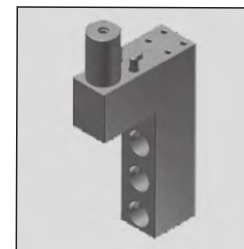

End face drilling holder
 Shank diameter: ø34
 Aperture: ø22
 Maximum outer diameter of blade: ø95

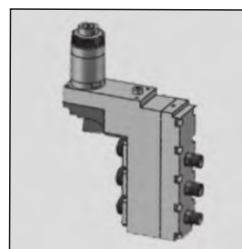

Front eccentric holder
 Maximum speed: 5000RPM
 Collet: 3×ER16+3×ER11

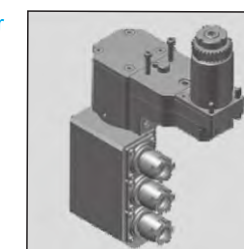

360° front rotary holder
 Maximum speed: 6000RPM
 Angle adjustment range: 180°

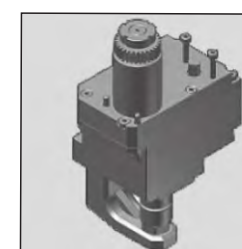

Saw milling holder
 Maximum speed: 4000RPM
 Saw blade aperture: ø12.7
 Maximum outer diameter of saw blade: ø95

Travel interferogram

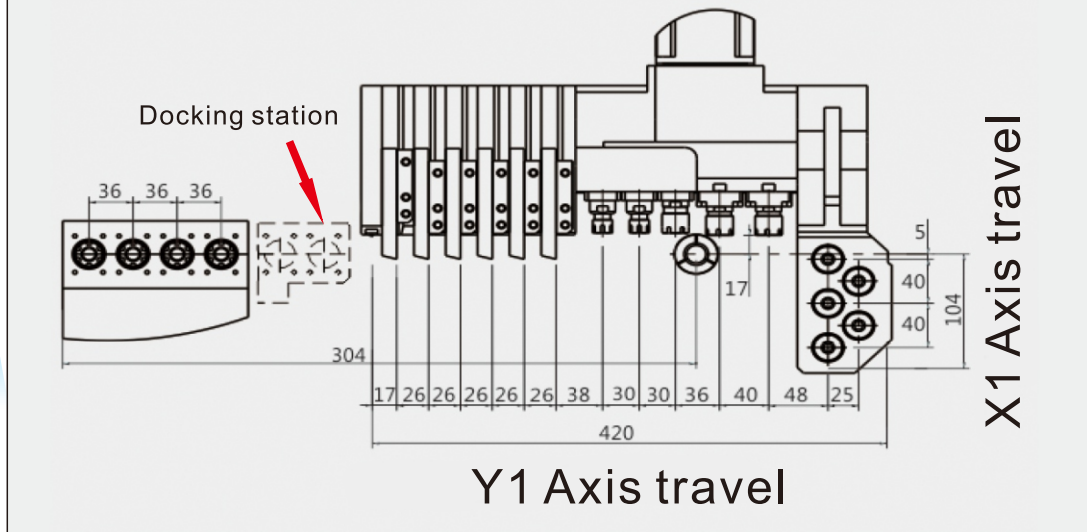

Non-guide bushing type

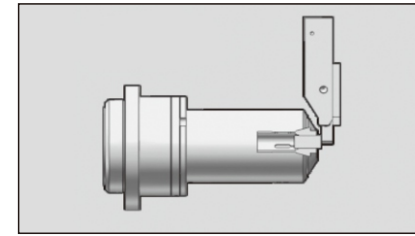

Guide bushing type

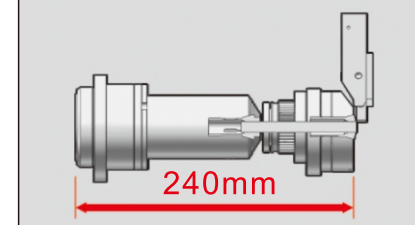

Guide bushing can be more accurate when processing long-size workpieces, Non-guide bushing type is for short workpiece.

Machine layout

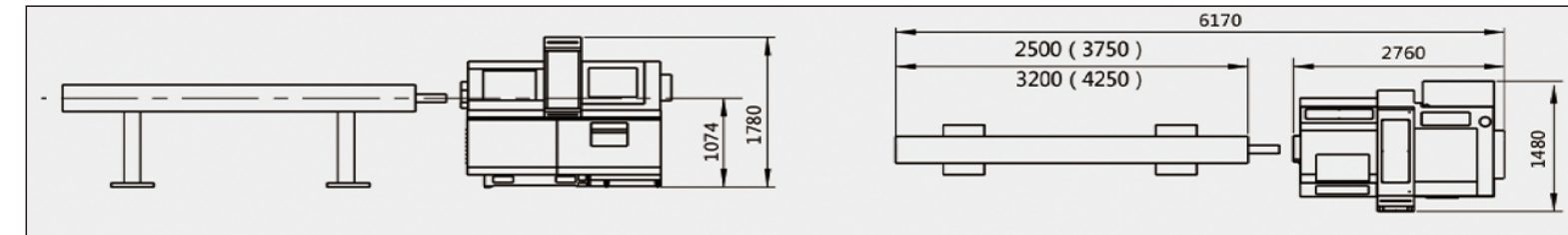

Optional configuration

Bar feeder



Mist collector



Chip conveyor



High pressure oil pump



Standard configuration:

- Mitsubishi M80 control system
- Main spindle chucking unit
- Back spindle chucking unit
- Rotary guide bushing unit
- Gang rotary tool driving unit
- Coolant unit
- Lubricating oil supply unit
- Cut-off tool breakage detector
- Workpiece receiver
- Main spindle coolant unit
- Electrical cabinet heat exchange
- Work lamp
- Chip box

SAMPLE MACHINING



TECHNICAL SPECIFICATION :

Model	Two-channel	ST-205	ST-265	ST-325
Capacity	Max. machining dia.	Φ 20mm	Φ 26mm	Φ 32mm
	Max. machining length	240mm		
	Max. drilling dia. of front side	Φ 10mm		Φ 13mm
	Max. tapping of front side	M8		
	Spindle through-hole dia.	Φ 23mm	Φ 28mm	Φ 38mm
Power	Control system	Mitsubishi M80		
	Machine power	11kw		15kw
	Main spindle speed	2.2/3.7kw		
	Back spindle speed	1.5/2.2kw		
	C axis indexing	0.001°		
Tool post	Main/back spindle speed	8000rpm		
	Feedrate	32(Y1/Z1/X2);24(Z2);20(X1)m/min		
	Feed motor power	1kw		
	Total number of tool	20pcs		19pcs
	Gang turning tool	6×□12	5×□12+1×□16	6×□16
Front side tool post	Cross rotary tool	2×ER11+3×ER16		3×ER16+1×ER20
	Max. drilling dia.	Φ 10		Φ 13
	Max. tapping	M8		
	Cross rotary tool speed	5000rpm		
	Cross rotary tool power	1kw		
Back side tool post	End face fixing tool qty.	5×ER16		4×ER16
	End face fixing tool dia.	Φ 10mm		Φ 13mm
	End face fixing tool tapping	M8		
	Back fixing tool qty.(I model)	4×ER16		
	Back fixing tool drilling dia.(I model)	Φ 10mm		Φ 13mm
Other	Back fixing tool tapping (I model)	M8		
	Back rotary tool qty. (II model)	4×ER16		
	Back rotary tool drilling dia. (II model)	Φ 10mm		Φ 13mm
	Back rotary tool tapping (II model)	M8		
	Back rotary tool speed (II model)	5000rpm		
	Back rotary tool power (II model)	1kw		
Machine size L×W×H	Machine size L×W×H	2760×1480×1780mm		2890×1500×1780mm
	Machine net weight	2600kg	2800kg	3000kg